

Smoke Alarm Training

Welcome!

Why are we here?

- To provide working dual sensing smoke alarms to families.
- To provide print information regarding smoke alarms, burn and fire prevention and the importance of creating and practicing a home escape plan.
- Have fun!

Smoke Alarm Facts

- Over 80% of US fire deaths in occur in the home
- There are more homes with non-working smoke alarms than without any alarm.
- Smoke alarms are one of the most cost / beneficial safety devices available.

Types of Alarms

We install “dual” sensing smoke alarms: Photoelectric **P** and Ionization **i**

“Dual” sensing means this alarm will detect both hot flaming fire and smoldering smoke.

P + **i** = Best

Batteries

Dual sensing alarms - use *ULTRALIFE* batteries

Existing Ionization alarms use 9 volt Energizer or Duracell batteries



Installation

- Install one alarm per house outside bedrooms (hallway)
- *Exceptions:* Split plan or split level - then install two alarms
- One on each level, outside the bedrooms.

Installation - Alarm Location

- Wall or Ceiling are both acceptable: *Avoid the 4” dead space where wall meets ceiling*
- Ceiling - At least 4” - 8” away from the nearest wall
- At the highest point for pitched or vaulted ceilings
- Wall - At least 4” but no more than 12” below the ceiling
- Mobile homes - Install alarm on **INSIDE WALL ONLY**
- **No Ceiling - No Outside Walls**

Installation - DON'TS

Do Not install alarms near or in:

Windows / Doors, Laundry Rooms, Kitchens, Garages, Air Ducts, Bathrooms, Ceiling Fans

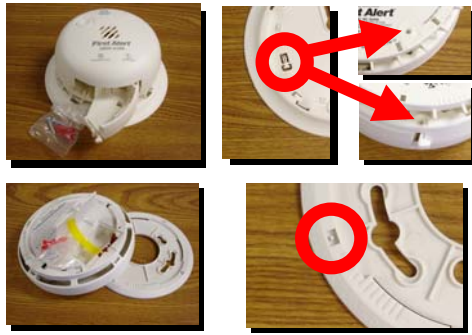

Kidde: break pins loose and insert in holes after installing battery and testing.

Locking Pins: Keep batteries from being removed.

First Alert: use tip of screwdriver and “bend pins over”

Black Bag Contents

(Red bags contain all necessary items - tools & alarms)



Kidde First Alert



Gray Bag contents

Possee Boxes
Safety Glasses
Vionex disinfecting wipes

First Aid Supplies
Tool Pouch - Hammer, Screwdriver, Awl
Red Bags may have Pliers and Measuring Tape.

Interacting with residents

- Identify yourself clearly. Speak slowly and sincerely. Make it clear you are not selling anything. Be persuasive but respect the person’s right to say “NO” to service. Provide brochures and information about the program.
- Respect resident’s property, time and privacy.
- **Get in, install and move on. No more than 10 - 15 minutes**
- Be sure to record activity, either on log or with waiver. If resident refuses to sign waiver, politely excuse yourself and leave.
- If resident signs the waiver, make sure **all lines are complete**. Someone from team must witness and sign the waiver with number and placement of alarms.

Testing

- (You): Test alarm before attaching alarm to installation plate
- (You to resident): Tell resident to test alarm monthly.
- Don’t remove Lithium (**ULTRALIFE**) battery from dual sensing alarm. It’s good for 5 - 7 years. Then replace the entire alarm.
- Periodically vacuum surface of alarm to keep it clean
- (You): Show instruction manual and **leave it with resident.**

Message for the Resident

- Develop a Home Escape Plan and practice, practice, practice!
- Never “borrow” a battery from an alarm.
- Never remove a battery just to avoid a “burnt toast” alarm.

DON'T FORGET TO LEAVE FACT SHEET AND MANUAL WITH RESIDENT

Questions?

Have fun!